

S.W. 1/4 OF SECTION 15, T.6N., R.1W., S.L.B. & M.

IN OGDEN CITY SCALE 1" = 200'

ALSO SEE PAGE 107-1

TAXING UNIT: 25

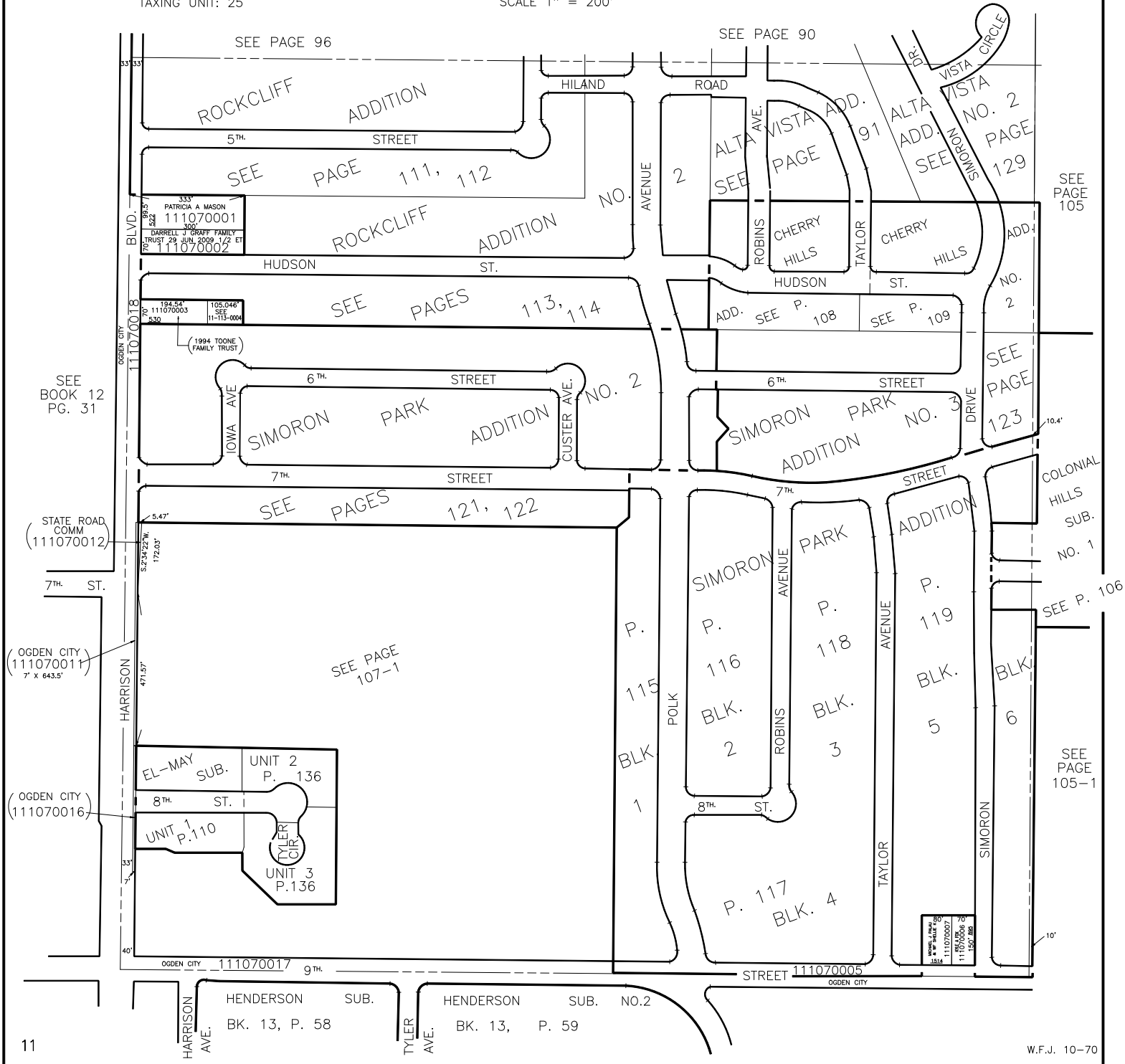

SEE BOOK 12 PG. 31

(STATE ROAD COMM 111070012)

(OGDEN CITY 111070011) 7' x 643.5'

(OGDEN CITY 111070016)

SEE PAGE 105

SEE PAGE 123

SEE P. 106

SEE PAGE 105-1